

# CCC Chapter 16.20 Update

What does the proposed language mean?

September 2012

*If the new code is adopted, does it mean that most development will need a stormwater permit?*

*No. These scale drawings and photographs illustrate the project scale necessary to trigger a stormwater review for a 1.5 acre and 5 acre property.*

*To trigger stormwater on a five acre property, the owner would need to construct a building or other impervious area larger than a super Walmart.*

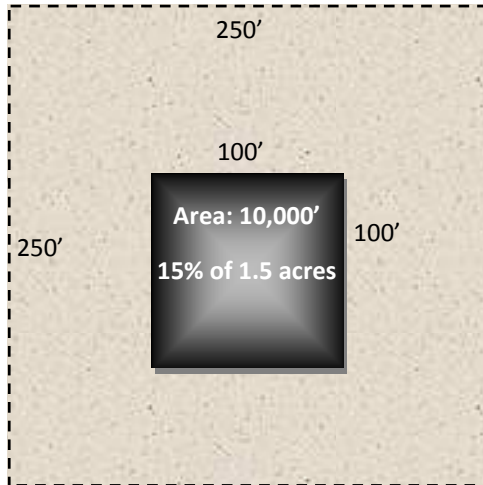

This riding arena is 7,560 square feet.

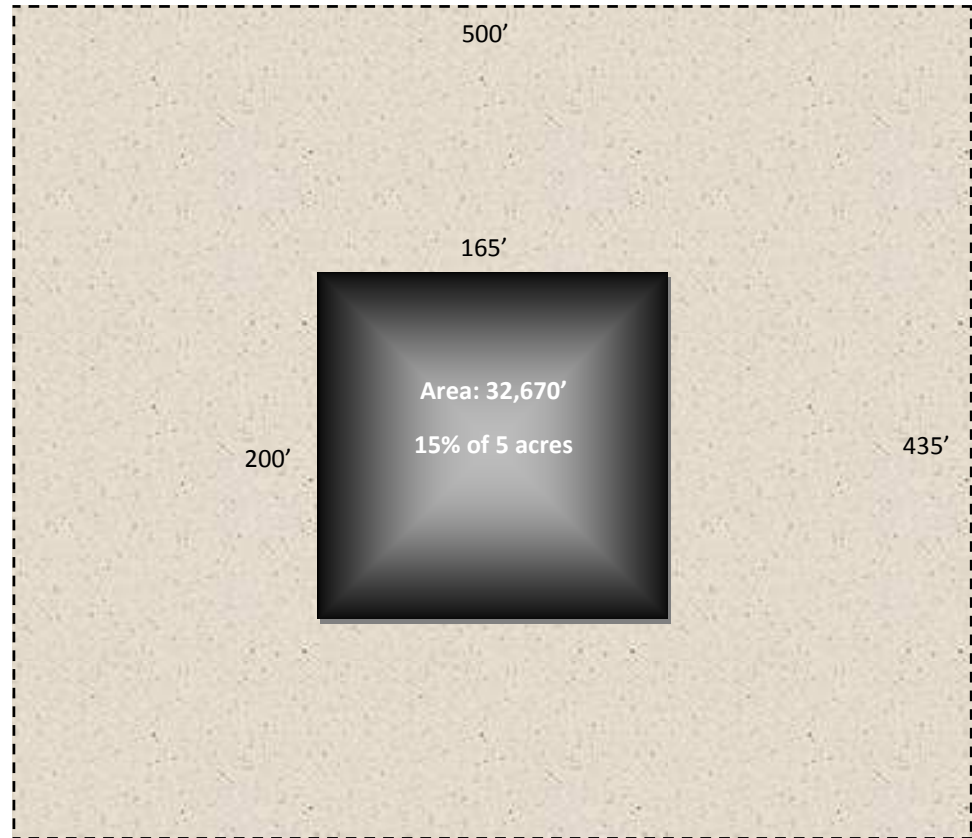

The new Longview Walmart is 30,000 square feet.